

RECOMMENDED MOUNTING HOLE
MAXIMUM PANEL THICKNESS: 5.5MM
RECOMMENDED MOUNTING TORQUE:
12 INCH-POUNDS MAX

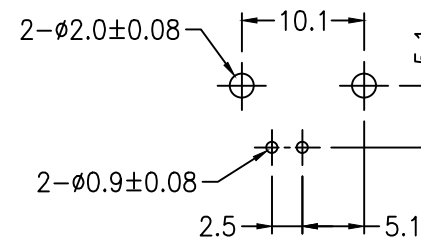

RECOMMEND P.C.B LAYOUT

7	CLAMP NUT	BRASS, NICKEL-PLATED	1	
6	LOCK WASHER	STEEL, NICKEL-PLATED	1	
5	SOLDER TAIL	COPPER, TIN-LEAD	1	
4	MOUNTING POST	BRASS, TIN-LEAD	2	
3	INSULATOR	DELIN	1	
2	BODY	ZINC ALLOY, NICKEL-PLATED	1	
1	CENTER CONTACT	PHOSPHOR BRONZE, GOLD-PLATED	1	
NO.	PART NAME	DESCRIPTION	QTY	REMARK

DIMENSIONS ARE IN mm [INCH]	TOLERANCES ARE FRACTIONS DECIMALS ANGLES	MATERIAL
MOLD NO.	0.5~6 = ±0.2 [0.008]	FINISH
BN-2178	6~30 = ±0.4 [0.016]	COLOR
	30~120 = ±0.6 [0.024]	

SAMAR

R/A BNC SOCKET, W/METAL
BODY, H: 13mm, 75ohm

P/N	BN-2178	DRAWN	YANG	DATE	07/28/2009
PROJECT NO.					
SCALE	1.6:1	SIZE	A4	SHEET	1 OF 1
					MT029